



## **Trim-Tronic**

External electronic control to be used in conjunction with all panic and emergency exit devices



Code

Min. ord.  
Multiple  
package  
Single  
package  
Status



**Trim-Tronic**

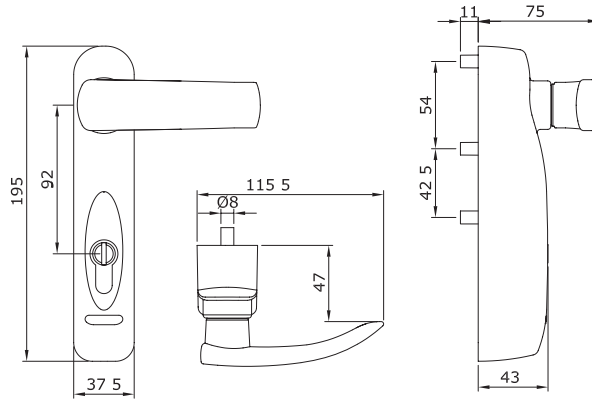

External electromechanical control for panic exit devices. Provided with **HANDLE AND EUROPEAN-PROFILE R6** cylinder ref. n. 880930109. **The Trim Tronic external electromechanical device allows the remote control of entries from emergency or panic exits. It can be used in combination with mechanical devices. It can be installed both on right- and left-hand doors.**

The cylinder allows handle enabling and disabling. The **2 leds** indicate the handle enabling status.

**Handle enabled and disabled by remote electric pulse connected** with cable (ref. 94403030E) and connector which also transfers the power supply and signals handle status.

The remote electric controls are:

Pushbutton 1: handle enabled for 5 seconds or for the time the pushbutton is pressed

Pushbutton 2: key disabled.

**Features:**

Zamak case. Idle handle if disabled.

Power supply 12 V D.C. Handle and key status signalling output (enabled/disabled)

Enabling/disabling pushbutton input.

Mechanical key locking pushbutton input.

European single-profile R6 cylinder, mm 40. Three keys.

Handle follower. Fixing screws. Template and assembly instructions.

**To be ordered separately:**

Feeder 12VDC-2A ref. n. 94403000E

Wing cable-guide ref. n.94403010E

Painted grey, with cable L 5,0 mt.	<b>94091103E</b>	B	1	-	1	YES
Painted white, with cable L 5,0 mt.	<b>94091104E</b>	C	1	-	1	YES
Painted black, with cable L 5,0 mt.	<b>94091105E</b>	A	1	-	1	YES

Min. ord.  
Multiple  
package  
Single  
package  
Status

Code

## Accessories



230 VAC. power supply - 12 VDC. - 3A

**94403000E** A 1 - 1 NO



External soft cable tube L= mm 300

**94403010E** B 1 - 1 NO



Built-in soft cable tube L= mm 300

**94403110E** A 1 - 1 NO



Connection cable 5 mt. for TRIM TRONIC.

**94403030E** C 1 - 1 NO









## **Trim**

External control  
for panic and  
emergency  
exit devices.

Code

Status  
Single  
package

Min. ord.



**Trim**



Door maximum thickness  
mm 105

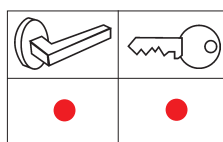
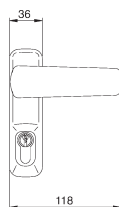
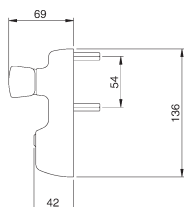

External control for panic exit devices. For fire resistant doors, supplied with **HANDLE** and 5-pin European profile **CYLINDER** art. 820930109. Kit of thermoexpanding gaskets. Handle follower. Fixing screws. Instructions.  
PVD finish

<b>94011002T</b>	A	1	-	1	NO
------------------	---	---	---	---	----



Door maximum thickness  
mm 105

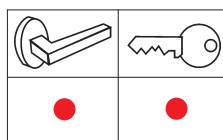
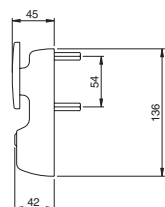

External control for panic exit devices. For fire resistant doors, supplied with **MOBILE KNOB** and 5-pin European profile **CYLINDER** art. 820930109. Kit of thermoexpanding gaskets. Handle follower. Fixing screws. Instructions.  
PVD finish

<b>94012002T</b>	B	1	-	1	NO
------------------	---	---	---	---	----



Door maximum thickness  
mm 105

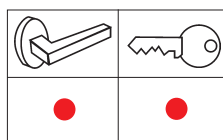
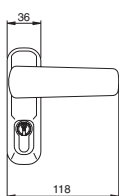
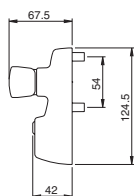

External control for panic exit devices. Supplied with **HANDLE** and 5-pin. European profile **CYLINDER** art. 820930109. Handle follower. Fixing screws. Instructions.  
PVD finish

<b>94021002</b>	B	1	-	1	NO
-----------------	---	---	---	---	----



Door maximum thickness  
mm 105

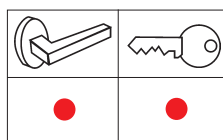
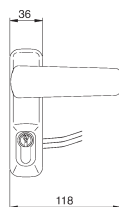
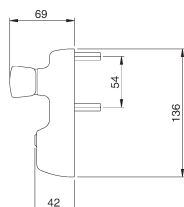

External control with microswitch for panic exit devices. For fire resistant doors, supplied with **HANDLE** and cylinder art. 820930109.

The **MICROSWITCH RELEASES** the signal of "handle locked" i.e. "Closed" and "Handle free" i.e. "open".

Door maximum thickness mm 105.

Painted grey	<b>94011013T</b>	D	1	-	1	YES
Painted white	<b>94011014T</b>	D	1	-	1	YES
Painted black	<b>94011015T</b>	B	1	-	1	YES

Code

Status  
Single  
package

Min. ord.



**Trim**



Door maximum thickness  
mm 105

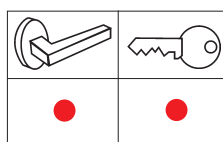
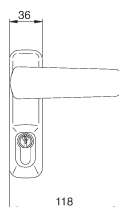
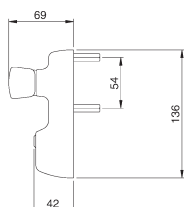

Painted external control for panic exit devices. For fire resistant doors, supplied with **HANDLE** and 5-pin European profile **CYLINDER** art. 820930109. Handle follower. Fixing screws. Instructions.

Painted grey	<b>94011003T</b>	A	1	-	1	YES
Painted white	<b>94011004T</b>	A	1	-	1	YES
Painted black	<b>94011005T</b>	A	1	-	1	YES



Door maximum thickness  
mm 105

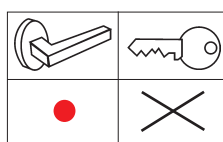
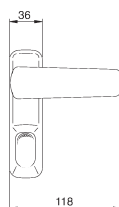
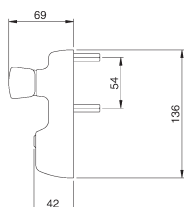

External control for panic exit devices. For fire resistant doors, **HANDLE ONLY**. Handle follower. Fixing screws. Instructions

Painted grey	<b>94014003T</b>	D	1	-	1	YES
Painted white	<b>94014004T</b>	D	1	-	1	YES
Painted black	<b>94014005T</b>	C	1	-	1	YES



Door maximum thickness  
mm 105

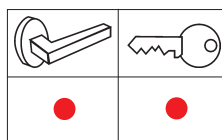
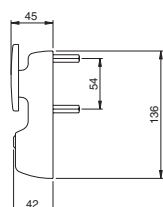

External control for panic exit devices. For fire resistant doors, supplied with **MOBILE KNOB** and 5-pin European profile **CYLINDER** art. 820930109. Mobile knob follower. Fixing screws. Instructions.

Painted grey	<b>94012003T</b>	B	1	-	1	YES
Painted white	<b>94012004T</b>	C	1	-	1	YES
Painted black	<b>94012005T</b>	B	1	-	1	YES



Door maximum thickness  
mm 105

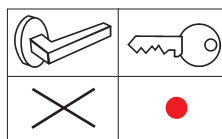
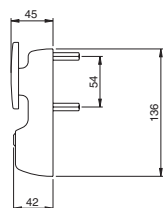

External control for panic exit devices. For fire resistant doors, supplied with **FIX KNOB** and 5-pin European profile **CYLINDER** art. 820930109. Fix knob follower. Fixing screws. Instructions.

Painted grey	<b>94013003T</b>	C	1	-	1	YES
Painted white	<b>94013004T</b>	D	1	-	1	YES
Painted black	<b>94013005T</b>	A	1	-	1	YES

**Trim**

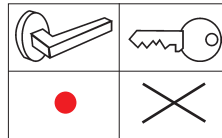
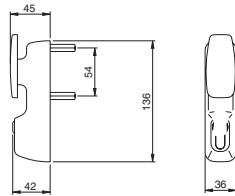

External control for panic exit devices. For fire resistant doors. **MOBILE KNOB ONLY.**

Handle follower. Fixing screws. Instructions.

Painted grey	<b>94015003T</b>	D	1	-	1	YES
Painted white	<b>94015004T</b>	D	1	-	1	YES
Painted black	<b>94015005T</b>	D	1	-	1	YES

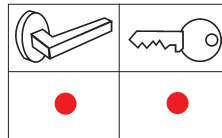
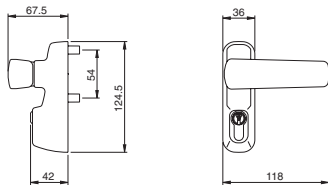

Painted external control for panic exit devices. Supplied with **HANDLE** and 5-pin

European profile **CYLINDER** art. 820930107. Handle follower. Fixing screws. Instructions.

Painted grey	<b>94021003</b>	A	1	-	1	YES
Painted white	<b>94021004</b>	B	1	-	1	YES
Painted black	<b>94021005</b>	A	1	-	1	YES

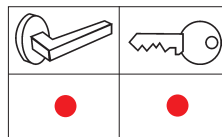
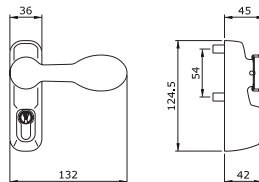

Painted external control for panic exit devices. Supplied with lowered **HANDLE** and 5-pin

European profile **CYLINDER** art. 820930107. Handle follower. Fixing screws. Instructions.

Painted black	<b>94021025</b>	B	1	-	1	YES
---------------	-----------------	---	---	---	---	-----

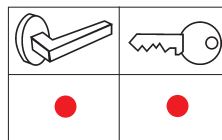
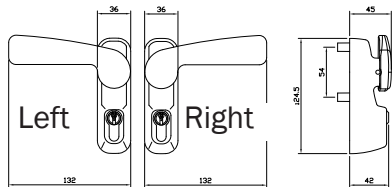

Painted external control for panic exit devices, supplied with lowered **HANDLE** and 5-pin European profile **CYLINDER** art. 820930107. Painted black. Handle follower. Fixing screws. Instructions. **NON REVERSIBLE.**

Left	<b>94021035..D</b>	C	1	-	1	YES
Right	<b>94021035..S</b>	B	1	-	1	YES

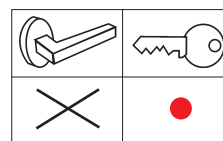
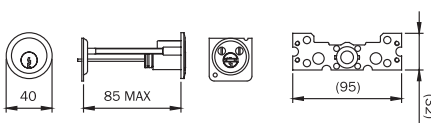

External cylinder for installation on doors with a maximum, thickness of mm 85.

Big 5-pin key. Plate and screws for inside fixing. Adaptor. Instructions. 3 keys.

Brass	<b>859000857</b>	C	1	10	10	NO
Nickel plated brass	<b>859000859</b>	C	1	10	10	NO





Code

Status  
Single  
package

Min. ord.



**Match for panic exit devices**



\* DC: maximum power  
supply time 10 seconds

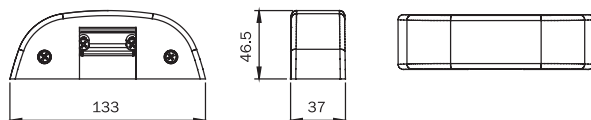

Electric striker for panic exit devices "IDEA Base" and "Push". **OPENING WITH PERMANENT RELEASE** by electric pulse. Suitable for PVC, wooden and aluminium frames, both coplanar and with rebate up to mm 24. Not suitable for fire resistant doors.

Power supply **12V. A.C. - DC 15W.**

Painted black	<b>5680000</b>	A	1	-	1	YES
Painted grey	<b>5680003</b>	B	1	-	1	YES
Painted white	<b>5680004</b>	D	1	-	1	YES

Electric striker for panic exit devices "IDEA Base" and "Push". **OPENING WITH LIMITED RELEASE**

(only during the electric pulse). Suitable for PVC, wooden and aluminium frames, both coplanar and with rebate up to mm 24. Not suitable for fire resistant doors.

Power supply **12V. A.C. - DC 15W.**

Painted black	<b>5680020</b>	C	1	-	1	YES
Painted grey	<b>5680023</b>	D	1	-	1	YES
Painted white	<b>5680024</b>	D	1	-	1	YES

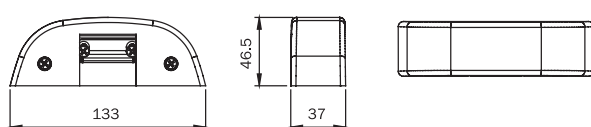

**COVERING KIT FOR ELECTRIC STRIKER 56800\***. Composed of:  
device cover and fixing plate.

**Electric striker to be ordered separately.**

PVD finish	<b>5680012</b>	C	1	-	1	NO
------------	----------------	---	---	---	---	----



Code

Status  
Single  
package

Min. ord.



## Keeps

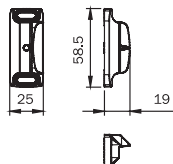

Keep for panic exit devices **"IDEA Base"** and **"Push"**, with top and lateral locking, zamak.  
For metal and wooden frames

Black zinc-plated

**94100090** B 5 - 5 NO

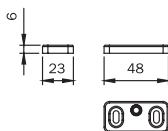

Keep for panic exit devices **"IDEA Base"** and **"Push"**, lateral locking, in stainless steel with spacers.  
Suitable for FIRE RESISTANT doors. For double doors. Universal for all profiles.

Stainless steel

**94100102** D 5 - 5 NO

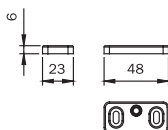

Keep for panic exit devices **"IDEA Base"** and **"Push"**, lateral locking, in painted steel with spacers.  
Suitable for FIRE RESISTANT doors. For double doors. Universal for all profiles.

Painted black

**94100100** D 1 - 5 YES

Painted grey

**94100103** D 1 - 5 YES

Painted white

**94100104** D 1 - 5 YES

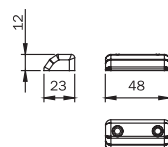

Keep for panic exit devices **"IDEA Base"** and **"Push"**, top and lateral locking, in stainless steel with spacers.  
Suitable for FIRE RESISTANT doors. Universal for all profiles.

Stainless steel

**94100112** D 1 - 5 NO

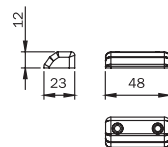

Keep for panic exit devices **"IDEA Base"** and **"Push"**, top and lateral locking, in painted steel with spacers.  
Suitable for FIRE RESISTANT doors. Universal for all profiles.

Painted black

**94100110** C 1 - 5 YES

Painted grey

**94100113** C 1 - 5 YES

Painted white

**94100114** D 1 - 5 YES



Code  
Status  
Multiple  
package  
Single  
package  
Min. ord.  
AMH  
GERM

**Keeps**

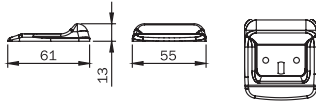

Keep for panic exit devices **"IDEA Base"** and **"Push"**, floor locking, in painted steel.  
Suitable for FIRE RESISTANT doors.

Painted black	<b>94100120</b>	B	1	-	5	YES
Painted grey	<b>94100123</b>	D	1	-	5	YES
Painted white	<b>94100124</b>	D	1	-	5	YES
Mt nickel finish	<b>94100127</b>	D	1	-	5	YES

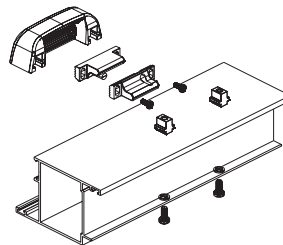
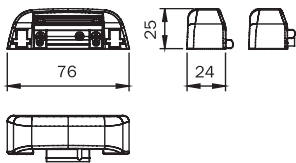

Adjustable PVD keep for panic exit devices **"IDEA Base"** and **"Push"** INOX, top or lateral for single and double doors.  
Suitable for coplanar frames and frames with a rebate up to mm 11. Fixing screws. Instructions.

PVD finish	<b>94100132</b>	D	1	-	5	NO
------------	-----------------	---	---	---	---	----

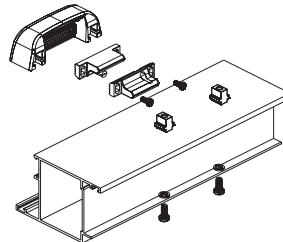
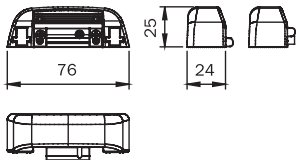

Adjustable PVD keep for panic exit devices **"IDEA Base"** and **"Push"**, top or lateral painted with zamak slide.  
For single and double doors. Suitable for coplanar frames and frames with a rebate up to mm 11.  
Fixing screws. Instructions.

Painted black	<b>94100130</b>	A	1	-	5	YES
Painted grey	<b>94100133</b>	B	1	-	5	YES
Painted white	<b>94100134</b>	B	1	-	5	YES

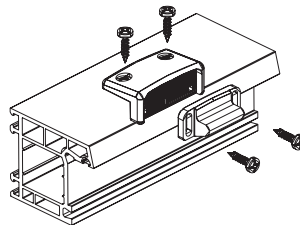
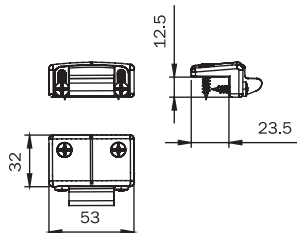

Adjustable PVD keep for panic exit devices **"IDEA Base"** and **"Push"** INOX, top or lateral  
For single and double doors. Suitable for frames with a rebate from mm 14 to mm 24.  
Fixing screws. Instructions.

PVD finish	<b>94100152</b>	D	1	-	5	NO
------------	-----------------	---	---	---	---	----



Code

Status  
Multiple  
package  
Single  
package

Min. ord.



**Keeps**

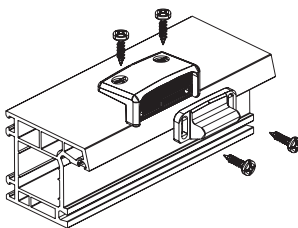
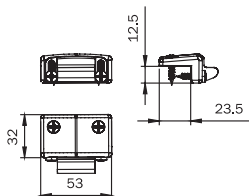

Adjustable PVD keep for panic exit devices **"IDEA Base"** and **"Push"** top or lateral locking painted with zamak slide. For single and double doors. Suitable for frames with a rebate from mm 14 to mm 24. Fixing screws. Instructions.

Painted black	<b>94100150</b>	A	1	-	5	YES
Painted grey	<b>94100153</b>	B	1	-	5	YES
Painted white	<b>94100154</b>	B	1	-	5	YES

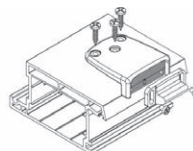
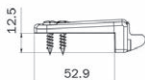
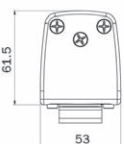

Adjustable PVD keep for panic exit devices **"IDEA Base"** and **"Push"** top or lateral locking painted with zamak slide. For single and double doors. Suitable for frames with a rebate from mm 14 to mm 24. Fixing screws. Instructions.

Painted black	<b>94100250</b>	C	1	-	5	NO
PVD finish	<b>94100252</b>	D	1	-	5	NO
Painted grey	<b>94100253</b>	D	1	-	5	NO
Painted white	<b>94100254</b>	D	1	-	5	NO

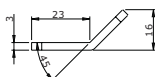
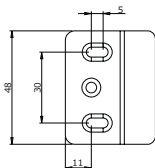

Steel lateral keep for panic exit devices **"IDEA Base"**, **"Push"**, **"Pad"** and **"Bolt"** also for FIRE RESISTANT doors.

Painted black	<b>94100145</b>	B	1	-	5	YES
Painted grey	<b>94100143</b>	C	1	-	5	YES
Painted white	<b>94100144</b>	D	1	-	5	YES

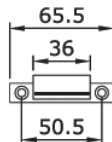
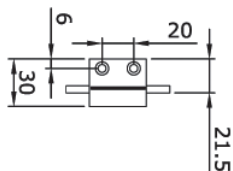

Nylon lateral keep for panic exit devices **"Push Bar"**. For wooden or PVC doors.

<b>949856</b>	C	1	-	1	NO
---------------	---	---	---	---	----

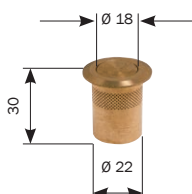

Brass floor bush with spring cap for rods. Inside hole Ø 18.

For **"Bolt"** panic exit device vertical rod.

<b>040807</b>	B	10	-	10	NO
---------------	---	----	---	----	----





Code

Status  
Single  
package  
Multiple  
package  
Min. ord.



**Accessories**

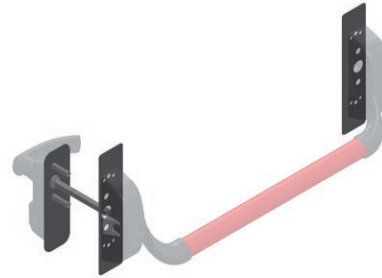
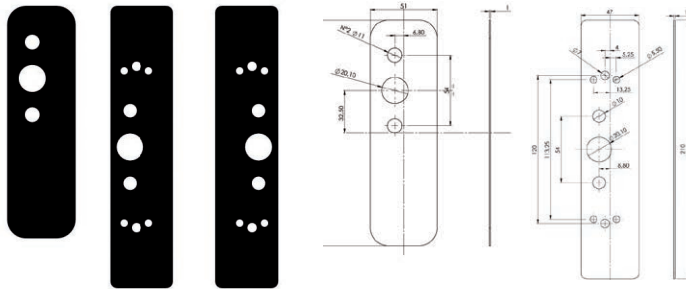

Retrofit plates kit, painted black. To be used with ISEO **"IDEA Base"** and **"Bolt"** series device for the **REPLACEMENT** of panic exit devices even not manufacture by ISEO.

1 plate for external control and 2 plates for devices.

**94100655** B 10 - 10 YES

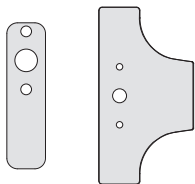

Kit of thermoexpanding gaskets for panic exit devices **"Push Bar"** and **"Trim"**  
For FIRE RESISTANT DOORS

**94000010** D 10 - 10 NO

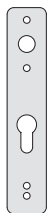

Kit of thermoexpanding gaskets, lock side, for panic exit devices **"Push Palmo"**  
For FIRE RESISTANT DOORS cod. 9449

**94000020** C 10 - 10 NO

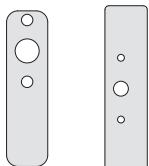

Kit of thermoexpanding gaskets for panic exit device **"IDEA Base"** and **"Trim"**  
For FIRE RESISTANT DOORS

**94000030** D 10 - 10 NO



Zinc-plated steel plate, for **"IDEA Base"** and **"Push"** for bar fixing.  
Suitable for fire resistant doors. Fixing screws.

**94100040** B 10 - 10 NO



Zinc-plated steel plate, for **"IDEA Base"** and **"Push"** for top/bottom latches fixing.  
Suitable for fire resistant doors. Fixing screws.

**94100050** D 10 - 10 NO



Code  
Status  
Single  
package  
Multiple  
package  
Min. ord.  
AMH  
GERM

## Accessories



Hold-open kit to be installed in the bracket of the **“IDEA Base”** and **“Bolt”** pushbars. **94100070** B 10 - 10 NO



Back housing, painted black, with hold-open function for **“Push”** 9424 series (page 6-36).  
Painted black **94200075** D 1 - 1 YES



Pair of small adhesive handles for the **“Push Bar”** chassis.  
Painted grey **94400073** D 1 - 1 YES  
Painted white **94400074** D 1 - 1 YES  
Painted black **94400075** D 1 - 1 YES

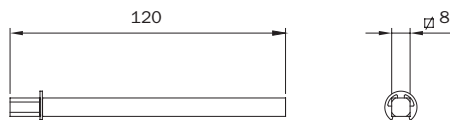

Extended handle follower for doors with thickness up to mm 105. **947880** C 10 - 10 NO



Accessory for rod guides. **94100195** D 10 - 10 NO



Plug in nylon for panic exit devices latchbolt, **“IDEA Base”** and **“Push”** type.  
GREY **94100703** D 10 - 10 NO  
WHITE **94100704** D 10 - 10 NO  
BLACK **94100705** D 10 - 10 NO

## Microswitches



Microswitch, to be installed in the bracket of the **“IDEA Base”** and **“Bolt”** chassis, used to detect door opening.  
Can be used with security system. Instructions. **94100060** C 1 - 1 NO



Microswitch, to be installed in the bracket of the **“Push”** 94254 chassis, used to detect door opening.  
Can be used with security system. Instructions. **94200060** C 1 - 1 NO



Microswitch, to be installed in the bracket of the **“Push Bar”** serie 944 chassis, used to detect door opening.  
Can be used with security system. Instructions. **94800030** D 1 - 1 NO